

February 2018

Official Magazine

Vol 72

Of the

No. 3



<https://www.tabletennis365.com/Liverpool>

# Editorial

Three quarters of the season gone already, with the 'main' events soon to come, page 19 has the finalists of all the Divisional Cup competitions, the Vets Cup down to last eight, the Final League tables of another successful JDD season.

All Divisional reporters have again sent in plenty to 'jog' a few memories, my thanks to Paul, Brian, Ian, Ken and Simon, and Paul Gittins has done an end of season report on the JDD and the benefits of encouraging youngster participation in sport.

Don Davies has done his Nets & Edges (pg.2) covering the City Teams, has uncovered some interesting data from time gone by, a mention of a 'Ping Parlour' (pg.5) started in an empty shop in Liverpool's St. John's Precinct, open to all from 10<sup>th</sup> March,

The Liverpool Closed will take place on Sunday May 6<sup>th</sup> 2018 at the Anfield Sport & Community Centre (entry forms out soon).

Early in this season, Francis Lay had a heart attack while playing at Bath St. Marine, and for the fact that a defibrillator was on hand in the Club house, events may not have turned out the way they did. Francis has since made a full recovery, even played a couple of matches, Francis has sent a personal 'thank you' to the BsM Club, Club Secretary Stan also sent an official thank you from the Wavertree Labour T.T.Club, so on this page is a

contact for any Club wishing and able to purchase a new defibrillator.

Jack Hunter – Spivey is on the 'Gold Medal' trail (pg. 14) and the L&DTTL has their first England No.1 (pg.14), the passing of an ex M/side Police player is also on pg.14.

The City of Liverpool Sports Forum gives recognition to a 'Volunteer of The Year' (Pg. 15).

Lawrence Kenwright will be remembered by a number of players who played in the higher divisions years ago, he has now made a name for himself in the world of Liverpool Business (pg. 16 – 17), and Bath St. Marine's Club House is changing with the refurbishment at Marine F.C.'s Stadium (pg.17)

There still seems to be an imbalance of players to Clubs, some clubs have so many players signed on but not enough teams to give them regular games, and some Clubs are gradually losing players and having to forfeit teams unable to fulfil fixtures without fines. A bit late in the season now, but it's a problem which can be helped by Club Secretaries 'helping' each other, if over loaded with players, ask around at the start of the season!

Nine weeks to go at time of this Editorial, good luck to those chasing promotion, and you know what, for those at the other end, aim to get back up the following season, but whatever, enjoy your table tennis if able to do so!

Table Tennis England have teamed up with Martek Lifecare to provide every club the chance to purchase a life-saving defibrillator at a discounted rate. Martek Lifecare provide the Defibtech Lifeline defibrillators which studies have shown to be the easiest to use.

The recommended retail price is £899 but our offer is as follows: Affiliated clubs: £739, Premier Clubs: £699

The offer includes: Lifeline AED (semi-automatic) or AUTO (fully-automatic)  
Pre connected adult pads  
Standard battery pack, Rescue ready kit  
Soft carry case, Wall bracket

To take advantage of this special offer, please contact Moya Murphy at Martek Lifecare on 07960 384488 or at [moya.murphy@martek-lifecare.com](mailto:moya.murphy@martek-lifecare.com) quoting the reference 'Table Tennis England'.

## Nets & Edges

The League's Men's team are in with a good chance of capturing the LCTTL Premier Division crown after the first of two weekends staged at the Hilton TT Centre in Horwich. With three matches to play, they lead the division thanks to a sets aggregate of 17 for and one against. When the final round commences, we open the morning session against second placed Warrington, also on six points with a 13 – 5, record. Next up will be Bury, before taking on the Chester/Ellesmere Port League, hopefully in the title decider, providing we've taken maximum points from our two previous fixtures, 'Port also have six points but, with an inferior sets aggregate of

14-10 having lost to Warrington, they also face Bury before completing their programme against our men. On the day though, I expect the title to be decided on actual match results rather than on sets aggregate.

The Ladies' competition finished in disappointing fashion after each team played just three fixtures. The LCTTL's Sam Holland subsequently asked all four Leagues if they'd like to play another weekend comprising of three more matches, this was after an approach from Manchester saying that the destiny of the title should be decided over six matches. Sam, who is the League's Finance

## Don Davies

Officer, had the unenviable task of dealing with the event and the queries which followed, he offered to extend the competition to a second round of matches providing all four Leagues' agreed to a suitable date. On behalf of the Liverpool League and appreciating the difficulty of arranging another weekend date, I advised Sam that we'd go along with the suggestion, hoping that they'd all agree, however, he arrived at an impasse after only the two Leagues agreed to extend the competition which resulted in the idea being abandoned. I have to say however, in these days of male/female equality, I find it surprising that a major title could be decided over one weekend of three matches, while the men enjoy a programme consisting of six matches decided over two weekends. Enough said on that one!

I recently came across an old cutting which may interest those of a certain age who played at that time, headed - 1962 Merseyside Open - 'Special'. This provided a detailed report of the Men's and Women's singles plus doubles, Junior Boys'/ Girls' and Veterans' singles. Although not mentioning entry numbers, with the exception of a few leading players' of the day, any other Liverpool based players had to qualify at the Dunlop factory in Speke on Friday night in order to play on the following day. These included George Smith, Peter 'Taylor', Wally Allanson and Arthur Taylor, although Roy Jones appears to have beaten Ted Mandaluff on Friday night, there was no mention of Roy playing on Saturday! I suspect, however, that Roy Smith also appeared on both days.

The Men's semi-finals saw Warrington's Mike Symonds account for Alan Tomlinson (New Zealand) while England international Brian Wright (Middlesex) beat Boston (Lincs.) Brian Hill. The report went on to claim that the final was as good as any witnessed in the tournament for many years, Wright, who married Mary Shannon, who also became England number one, won an exciting battle, 21-19 in the third.

Chester Barnes made a rare appearance in Liverpool and in doing so chalked up his fifth consecutive Junior Boys' title beating David Stanley 21/14, 21/16 in the final. The tournament, one of the most prestigious in the country, over the years attracted many famous international players and the who's who of champions includes Victor Barna (5 wins) Johnny Leach and Denis Neale with four each and Richard Bergmann (3) are just a few of which present day players will be aware.

Of course, the sport in those days was very popular and to be a part of those august personalities was an incentive and big draw for Merseyside players, hence the need to have to qualify just to be included in Saturday's event.

Although I'm sure the exploits of Harry Watson will have been highlighted by the division one correspondent, I'd also like to add a few comments on his recent achievements in division one, playing for the Police A team. The 15 year old became the only player to beat Ritchie Venner and Paul Hutchings in the same match which is quite a

remarkable achievement, I'm sure most of those playing in division one, will agree. I have to add, however, his coach, former England international Andrew Rushton, has strongly advised him and other up and coming 'pupils' not to play in local league matches! This 'advice' cost Harry the chance to play for the men last season but, when asked to make his debut in the Premier Division at the Hilton Centre in December, he accepted the invitation, joining Paul and Ritchie. The trio won all three matches, 6-0, 6-0 and 5-1, Harry losing the odd set 10, 9, and 6 on his first trip to the table to a tricky combination bat player but, recovered well to win his next two contests. The competition, comprising of three more fixtures, will be completed on Sunday April 8<sup>th</sup>, also at the Hilton centre, although, the team at the time of compiling these notes, has still to be formulated.

I contacted a number of clubs who have 'elderly' veteran players' registered who regularly play, with a view to staging a tournament for those over 60, 70 or 80. I was surprised to have received just one reply, that being from Graham Turner who said BSM would consider the invitation when further details became available. With the League having so many players registered in these age groups, one would have expected a more positive response.

#### **PING is BACK.**

I recently received details of this year's event which is due to kick off in March. An unoccupied shop in St. John's Precinct in the city centre has been assigned for indoor play, this being handed over to TTE on March 10<sup>th</sup>, although by the time you read this issue, I expect the event to be under way. Tom, however, has posted details on the L&DTTL 365 site and will enlarge on the event as soon as more details become known. That being said, if you are willing to offer help in any way in the following months in which it will run, please contact me on [dondavies77@hotmail.co.uk](mailto:dondavies77@hotmail.co.uk)

The 2018 Bill Fawley Closed championships, sponsored by Bill himself, will again be staged at the Anfield Sport and Community Centre, Breckside Park, Lower Breck Road, Liverpool L6 0AG on Sunday May 6<sup>th</sup> - tel. 263 6186. Entry forms will be circulated to club secretaries towards the end of March or early April.

Finally, can I ask team captains or, who ever enters the details on the match card, to print names so as they are legible and to take care when scanning them to Tony. I have decided to overlook those which are difficult to decipher which may mean they aren't included in the Echo column or the Digest N&E / L&CTTL. Please remember, this is an official 'League document and one which should be treated with respect, a point which I'm sure will be appreciated by Tony Dixon who has the onerous task of examining them for eligibility purposes.

## Division 1.

## Paul Hutchings

As we reach the beginning of March, the division is shaping up much as I predicted at the start of the season. Crosby High are back on top after 17 matches played, with a lead of 3 points over Maghull in second, who have a game in hand. With the return of Jack Dempsey, Crosby are looking capable of producing a series of 10-0 victories against teams in the lower half of the division to close the gap against Maghull and I believe they will eventually take the title at the end of the season.



In the top of the table clash Crosby managed to defeat Maghull 6-4 which included 2 wins for Jack, Rhys and Yameen, but an excellent 4 from Ritchie Venner may have single handedly kept Maghull in the title race. Maghull may have been helped on the night by the decision for Jack not to contest the doubles and due to a mix up over the colour of his new rubbers, Jack was forced to play without his normal antiloop. Both Rhys and Yameen continue to improve as the season has progressed and will be strong contenders for the Closed tournament should they enter. Having been involved in the Junior circuit with Amy over the last few years, I am aware of all of the hard work, travelling, practise and effort that goes into reaching this standard of play. This is a massive team effort from Dave and the Crosby High club along with the support of parents and it will be just reward for everyone involved, if this group of home grown players do eventually lift the title. The rest of the league may just have to wait until they go off to university to regain the title but Dave will inevitably have a new crop of aspiring players to come through and there are few coaches and clubs in the region who consistently produce players to this standard, well done Dave.

Maghull will continue to push all the way but will need a number of high scoring wins if they are to maintain their slender advantage, Ritchie Venner continues to have an excellent season, and together with myself, have played in every match this season. Brian Oldfield continues to acclimatise to the division and his recent 2 wins in the cup against Joe Mullen and Josha Matthewman bodes well for the rest of the season.

Jaguar and Police continue to lead the rest of the division with games in hand over Crosby and Maghull, but are unlikely to challenge the top two. For Jaguar, Andy Taylor continues to lead the way on 81% from 44 sets played with solid support from Andy Town and Paul Kinsey, but will need more than the 17 sets from Terry Turner if they are to produce a late challenge. Police continue to struggle to turn out their strongest team with 27 sets played by reserves and this explains their current fourth position, however they will be hoping to take the cup when they meet

Maghull in the final later in the season and could benefit from moving Harry Watson up to a squad of 4 in the first team for next year to mount a serious challenge again.

The rest of the division is tightly packed with 9 points separating the next five teams, with games in hand and different teams to play, it is impossible to predict the running order by the end of the season and it will massively depend on who turns out and for which matches. Police 'A' have called upon 9 players this season with Harry Watson the best of the bunch with 13 wins from 15 including an excellent three against Maghull.

Paul Gittins has produced some excellent performances since Christmas with 2 outstanding wins over Keith Williams and Andy Taylor and may well be a dangerous floater for the closed in the singles and vets. Harold House are having an excellent season and may well finish fifth if Jake Shaw can play more than his 15 sets and Kevin Lewis maintains his excellent form on 68%.

Wavertree Labour remain comfortable in their mid table position, with Thomas Haddley winning virtually all of their sets, although Arash continues to improve with good wins over Dave Tagg, Matthew Laird and Dermot Tierney in recent weeks. Greenbank struggle to call on a regular three players with Keith Bird not being available and with 11 players turning out so far have struggled to climb up the division. Ming Lui has been the bedrock of the team with 46% from 39 sets played, and the best of the reserves being George Lennon who has 58% from 12 sets, including wins over Cherith Graham, Brian Oldfield, Claire Peers and Dermot Tierney. Greenbank 'A' have had similar issues with reserves, having used 8 players so far, but have been able to call on Pawel Orzechowski whose 7 matches have included excellent wins over Andy Taylor, Terry Turner, Ritchie Venner and myself, losing only to Keith Williams, Thomas Haddley and Yameen, Dave Tagg is the most consistent performer with 39% from 33 sets played.

I continue to very disappointed at the lack of progress by Greenbank Sports Centre to make the table tennis room more suitable for match play, and the relentless clambering over mobility equipment to retrieve the ball not only prolongs the night but breaks the flow of the match and will potentially cause an accident at some stage.

Bath Street will move up the division as they play their games in hand and have been helped massively by Keith Williams playing in nine of their matches with an 88% average, Dermot Tierney, Dave Roberts and Claire Peers continue to turn out regularly and this regular squad can prove a difficult team to beat on the night.

At the bottom end of the table it looks as if Crosby High 'A' and East Wavertree will be relegated at the end of the season unless something dramatic happens, when we played East Wavertree earlier in the season I know that they were looking forward to the season ahead and wanted to see how they could compete with the better players. Both Alan Davies and Neil Colville have continued to make the most of their opportunities with some excellent wins, Alan's recent victories have included Arash Khozoe, Roy Smith and Andy Town, and an important double against Crosby High 'A' defeating Roger Neal and Sylvia Graham just before Christmas, Alan has also gone to 5 against Yameen, and Pawel and would probably benefit from another season in the first. Similarly Neil has produced a fine set of performances since Christmas including three against Crosby High and wins over Peter Findlatter, Joe Mullin, Peter Lee, Dave Tagg and Arash to name but a few. Crosby High 'A' have managed to field a regular team for most of the season and certainly Sylvia has enjoyed the opportunity of measuring herself against the top players in the division, the majority of the sets won have come from Chris Spedding on 45% from 37 sets played, and the team have done well to keep going despite regularly losing each week, both teams will benefit massively from this season and should quickly get back to winning ways should they be relegated to Division 2.

So finally some thoughts on the season so far.

- Should all teams provide refreshments for the away side?
- Should the team captain be given responsibility for his players conduct on the table?
- Should there be a scheduled practise time for the away team from 7.15pm to 7.30pm to improve the quality of the matches?
- Should we dispense with the doubles given that matches often finish after 11pm?
- How do we encourage the better players in the division to turn out more regularly?
- Should we have an order of merit award for the player who wins the most sets over the season?
- How do we increase the number of players playing in the Closed at the end of the year?

And finally, is the season too long with too many free weeks? Should we be still playing competitive league matches in May?

Enjoy the rest of the season.

## ***PING PONG PARLOUR***

Each summer, for a number of years, Table Tennis England has organised Ping! which is a programme to highlight social table tennis. Tables have been placed at various locations around the city and members of the public have played social table tennis.

**This year (2018) the organisers of the Ping! programme have arranged for a Ping Pong Parlour to be opened in St. Johns Shopping Precinct, Liverpool. The parlour, which is due to open on Saturday 10/3/18, will be open between 10am-5pm Mon-Sat and 11am-5pm on Sundays and will allow the public to play table tennis on a number of tables in an unused shop premises in St. Johns precinct.**

**The Ping Pong Parlour is located on the Lower Level of the precinct at 39B Dawson Way and will be open to all who want to play table tennis. So if you are a complete beginner or an experienced league player you are invited to visit the Parlour and play table tennis.**

Please pass this message onto your friends and colleagues.

Volunteer players are always welcome to call in, play, and maybe help out

***BSM Club had a lovely card from Francis Lay, thanking the club for the attention he received from the staff at Marine Football Club and our own members on the night of his illness. Make a good recovery Francis, we all need you back on the Liverpool League table tennis circuit.***

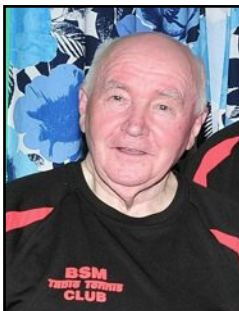

This second half of the season is going to be a tough fight between BSM "A", East Wavertree "B" and Maghull "A", for the 2 promotion places with CADWA being an outsider in this fight. Best not say too much about the valiant teams fighting at the bottom of the division, except to say they are all enjoying the matches.

## MATCH WEEK 9.

BSM "B" 5 v ARRIVA NW.5 John Rowan was the star man in this match winning 2 games and teaming up with Krzysztof to take the doubles. Mal Kent had a good win over John Rowan and Brian Crolley had an equally good win over Krzysztof to earn BSM "B" a draw. East Wavertree "A" 6 v Merseyside Police "B" 4, Joey Williams won his 3 games, the other wins came from a new comer to me called Tom Creevy and 1 win for Paul Loftus for East Wavertree "A", Matt Evans won 2 and John Moore had a tremendous win over Paul Loftus, then Matt and Dave McMahon took the doubles to get 4 valuable points for Merseyside Police "B". Bootle YMCA 4 v BSM "A" 6, Wayne Percival put on his usual top level performance to record his 3 wins backed up by a win for Alan Chase to get 4 points for Bootle YMCA, however BSM "A" put in a steady effort from Matt Wilson 2, Colin Turner 2, and Barry Davis 1 win, Matt Wilson and Colin Turner took the doubles to give BSM "A" a fine win. East Wavertree "B" 4 v Maghull "A" 6, this was some battle particularly the game of Paul Banks v Lee Madin, Lee winning 11-9 in the 5<sup>th</sup> game, the other tussle was Mathew Cranny's win over Hassib Nuree 11-9 in the 5<sup>th</sup>, both these teams are class acts, and a pleasure to play against. Wavertree Lab. "B" 3 v CADWA 7, I am looking at the 3 wins for Wavertree lab "B", Phil Luxon, Dave Harse and Jet Hou, as ever this must have been a very good match, with the big difference of Graeme Black winning all his events in good style.

## Match Week 10.

BSM 'B' 2 v Bootle YMCA 8, Bootle YMCA had Alan Chase, John Higham, Liam Shaw and Ted Birch out for this match, Ted played very well in the doubles with Alan, Alan won all his singles and Liam and John won 2 each. BSM 'B' picked up 2 good points, Brian Crolley beating John 11-9

in the 5<sup>th</sup> and Andy Cheung beating Liam 13-11 in the 5<sup>th</sup>. Maghull 'A' 6 v Wavertree Lab. 'A' 4, Wavertree Lab. 'A' put up a fine performance with Michael Dugdale and Alan Liu getting the better of Paul Banks, and Michael beating Steve Braddick, also Andy Bird and Michael beating Steve and Michael Stewart in the doubles, this must have been the highlights of this match, Michael being the man of the match winning all 3 of his games for Maghull 'A', Steve winning 2 and Paul 1 to get the win for Maghull 'A'. Arriva N.W. 5 v East Wavertree 'B' 5, John Rowan

got his money's worth by winning all his 3 matches and teaming up with Krzysztof Lenyk to take the doubles, Krzysztof beat Joey Williams in the 5<sup>th</sup> to secure the draw for Arriva N.W, Lee Madin won 2, Hassib Nuree won 2 and Joey Williams won 1 for East Wavertree 'B'. Merseyside Police 'B' 0 v BSM 'A' 10, a good win for BSM 'A' against a competitive side of Brenda Buoe, Mick Winder and John Moore all standing in as reserves, but despite some terrific effort they could not overcome BSM 'A's Matt Wilson Barry Davis and Colin Turner. CADWA 8 v Bootle YMCA 'B' 2, Graeme Black was the star of this match winning all his 3 games and taking the doubles with Paul Evans, Peter Taylor still turned on the style, to take 2 wins, Paul also recorded 2 wins for CADWA, Shakil Malik had to fight real hard to get his wins over Pater Taylor and Paul Evans for Bootle, both very close in 5.

## MATCH WEEK 11.

EAST WAVERTREE 'B' 10 v BSM 'B' 0, a very good nights table tennis, but the East Wavertree team of Lee Madin, Hassib Nuree and Tony Dixon were just too strong for BSM 'B', the score stands for itself but it was a good sporting night out. Wavertree Lab. 'A' 4 v Arriva N.W. 6, John Rowan was the star man in this match well backed up by Krzysztof Lenyk for Arriva, but Wavertree Lab 'A' always put up a good team performance, Alan Liu winning 2 games and Andy Bird and Michael Dugdale picking up 1 each. East Wavertree 'A' 3 v CADWA 7, Graeme Black putting in another good performance for CADWA supported by Mike Power and Alan Evans, East Wavertree getting their points from Lee Madin 2 and Hassib Nuree 1. Wavertree Lab. 'A' 5 v Maghull 'A' 5, Dave Harse won his 3 games, Jet Hou 1 and Andy Lloyd 1 getting the 5 for Wavertree 'A', Matt Cranny and Michael Stewart winning 2 each and teaming up to take the doubles making it a fine drawn match.

## MATCH WEEK 12.

BSM 'B' 4 v Wavertree Lab. 'A' 6, a very strange match this one, Brian Crolley, was late arriving at this match

and he was the key holder, Andy Bird, Alan Liu and Michael Dugdale were most accommodating and only thanks to these players and Andy Cheung the reserve key holder and Mal Kent who helped to get this match completed, and a lovely match it was, can I thank all these players for covering for my late arrival. Alan Liu was the star man of this match winning his 3 games, Andy Bird got 2 and Michael Dugdale 1 for Wavertree Lab 'A', Andy Cheung and Mal Kent won the doubles and Andy, Mal and Brian got 1 each to get 4 points for BSM 'B'. Maghull 'A' 8 v Bootle YMCA 'A' 2, best game of the night was Shakil Malik's win over Paul Banks, this was followed by Matt Cranny and Michael Stewart winning the doubles over Shakil Malik and Liam Shaw. Arriva 2 v Wavertree Lab. 'B' 8, M o M was Rob Bevan winning his 3 games and pairing up with Phil Luxon to win the doubles, John Rowan got Arriva's 2 points beating Phil Luxon and Dave Harse. East Wavertree 'B' 5 v Bootle YMCA 5, Hassib Nuree was the star of this match, but the real heroes were Alan Chase 2, John Higham 2 and Ted Birch 1 to claw a well earned draw for Bootle YMCA. CADWA 6 v BSM 'A' 4, this was a fine win for CADWA, but mainly due to their star man Graeme Black, Matthew Wilson won 2, with Colin Turner and Barry Davis won 1 each to get 4 valuable points for BSM 'A'.

#### MATCH WEEK 13.

Wavertree Labour 'B' 7 v BSM 'B' 3, Phil Luxon and Rob Bevan were just too good for the BSM 'B' team, with Phil entertaining the crowd with his "world famous googly returns" which as ever baffled his opponents, it all made for a very good nights table tennis with 3 hard fought points won by BSM 'B'. Wavertree Lab. 'A' 2 v East Wavertree 'B' 8, once again East Wavertree Lab. 'B' performed like a promotion team overwhelming a very good Wavertree Lab 'A' side, only Alan Liu and Andy Bird winning 1 each to get 2 valuable points for their team.

#### MATCH WEEK 14.

East Wavertree 'A' 6 v Arriva N.W. 4, it's great to see Joey Williams stepping in as another super sub and recording his 3 wins, he had to fight real hard to beat John Rowan and Krzysztof both in the 5<sup>th</sup> game. Bootle YMCA 6 v Wavertree Lab. 'A' 4, Chase, Birch and Higham can still do it even against the young blood of Bird, Dugdale and Lui of Wavertree 'A', the enthusiasm of all these player is to be admired. Wavertree Lab. 'B' 6 v East Wavertree 'B' 4, this was a tough encounter with Rob Bevan being the Star man winning all his 3 and teaming up with Phil Luxon to win the doubles, Dave Harse, team Captain winning 2 to give Wavertree 'B' a deserved win. BSM 'A' 9 v Maghull 'A' 1, this was some win for BSM 'A' with Matt Wilson, Barry Davis and Colin Turner putting in magnificent performances to beat a very strong Maghull 'A' side of Paul Banks, Matt Cranny and Michael Stewart. Bootle YMCA 'A' 8 v BSM 'B' 2, a very good match, some great table tennis but overall the YMCA team of Shakil Malik, 7

Liam Shaw and Steve Daniels were the better side, Mal Kent was by far the best player on the BSM 'B' side.

#### MATCH WEEK 15.

BSM 'B' 3 v East Wavertree 'B' 7, Tony Dixon and Joey Williams were far too good for BSM 'B', a good match played in the spirit of the game, Lee Madin played his part as a supporter, helping umpire nearly all the games to make the night. Maghull 'A' 4 v Merseyside Police 6, Maghull must have thought "what's wrong here!", where did this new player in the Police team come from, Abdulraham Alsuwailem playing for the Police and winning all his games in good style, Matt Evans and John Dyson getting 1 each to get the win for the Police, Matt Cranny and Michael Stewart had to fight tooth and nail to get 2 each for Maghull 'A' in very hard fought game. My biggest problem as the writer of these notes is to how to shorten the new players name and secondly my team has to face him in 2 week time. Arriva N.W. 3 v BSM 'A' 7, some ups and downs in the game between Matt Wilson and John Rowan, John Rowan got 2-1 in front and then it all fell to pieces with Matt Wilson winning 3-2, Krzysztof Lenyk had to fight real hard to beat Colin Turner 11-9 in the 5<sup>th</sup>, Barry Davis put in his usual steady performance to get his 2 wins, we can't forget Graham Rollinson's fine efforts every week for Arriva. East Wavertree 'B' 8 v Bootle YMCA 'A' 2, Shakil Malik put in a fine performance to beat Lee Madin very close in the 5<sup>th</sup> and to lose to Hassib Nuree and Tony Dixon in the 5<sup>th</sup>, Liam Shaw did very well to beat Tony Dixon. Wavertree Lab. 'A' 2 v Wavertree Lab. 'B' 8, Andy Bird and Alan Liu both beat Mario Giove to record the 'A' teams two wins, all the rest of the games went according to form, but a good match. CADWA 'A' 6 v Bootle YMCA 4, Ted Birch had a tough night out, going to 5 to beat Mike Power and going to 5 to lose to Peter Taylor, In addition playing Graeme Black and playing the doubles as well, no stopping this fellow, Alan Chase and John Higham did o.k. as well for Bootle YMCA, Mike did well to beat John Higham to give CADWA the 6-4 win. I am not too sure what Graeme Black was doing in the same room as all these older players, who are all in their late 70s, wonderful to see how they perform.

#### MATCH WEEK 16.

BSM 'A' 10 v BSM 'B' 0, possibly the least said about this match the better, Matt Wilson, Colin Turner and Barry Davis were just too good for Mal Kent, Brian Crolley and Keith Dudley, I don't think that even the missing Andy Cheung would have made any difference. Wavertree Lab. 'B' 5 v Bootle YMCA 5, Rob Bevan was the star of this match winning all his 3 games and pairing up with Dave Harse to take the doubles for Wavertree Lab. 'B', but as I see it all players put in good performances, with Ted Birch and John Higham picking up 2 each and Alan Chase getting the last one for the draw. Merseyside Police 8 v Arriva N.W. 2, a very good win for the Police, but the wins for

John Rowan and Krzysztof Lenyk over another newcomer, Ruben De Antonio Liedo are well worth a mention for Arriva. Jon Dyson does not get a mention to often but he and Abdul Alsuwailam both won 3 each and paired up to win the doubles, great Stuff. East Wavertree 'A' 0 v East Wavertree 'B' 10, this is another match where Lee Madin, Hassib Nuree and Tony Dixon were just far too good for their club mates of Jimmy Williams, Tom Creevy and Carl McCauley.

#### MATCH WEEK 17.

BSM 'B' 1 v M/S Police 9, this was a tough match for BSM 'B', most things going to the better team, but BSM put up a good fight right up to the end when Mal Kent got our only point going right to the wire to get his win. Maghull 'A' 6 v CADWA 4, Paul Banks, Michael Stewart 2 each and Matt Cranny 1, and teaming up with Michael Stewart to win the doubles and win the match, as ever Graeme Black was the man of the match for CADWA with Mike Power getting a fine win over Matt Cranny. Wavertree Lab. 'B' 7 v Bootle YMCA 'A' 3, Phil Luxon and Rob Bevan were the stars of this match winning all their games and teaming up to win the doubles as well, Shakil Malik, Liam Shaw and Richard Winckle all won 1 each for Bootle YMCA 'A' to get a very creditable 3 points for their team. East Wavertree 'B' 7 v BSM 'A' 3, East Wavertree 'B' put up a strong performance against a weakened BSM 'A' team, Lee Madin and Hassib Nuree won 3 each, and Tony Dixon won 1 to get 7 valuable points for East Wav. 'B', Barry Davis and Colin Turner got 1 each and teamed up to take the doubles to reduce the damage. Wavertree Lab. 'A' 4 v East Wavertree 'A' 6, Alan Liu did well to beat Paul Loftus

and Tom Creevy, also Andy Bird winning 1 and teaming up with Michael Dugdale to win the doubles for Wavertree Lab 'A', Tony Mullally pitched in with 3 wins, Paul Loftus won 2 and Tom Creevy won 1 to get the win for East Wavertree 'A'.

#### MATCH WEEK 18.

BSM 'A' 10 v Wavertree Lab. 'A' 0, the BSM team of Matt Wilson, Colin Turner and Barry Davis were just too strong for Wavertree Labour 'A's team of Andy Bird, Michael Dugdale and George Liu. CADWA 8 v ARRIVA N.W. 2, Graeme Black and Paul Evans played well winning all their games, Mike Power picking up 1 and teaming up with Graeme Black to get the doubles for CADWA, but I like to see John Rowan and Krzysztof Lenyk picking up 1 each to get 2 good points for Arriva N. W. Bootle YMCA 'A' 6 v Bootle YMCA 4, so who is Craig Lee? welcome to the 2<sup>nd</sup> Division Craig, it's always good to see a new face, Craig did so well to win his 3 games in good style, he was backed up by Shakil Malik winning 2 and Liam Shaw 1 to get the win for the YMCA 'A's team, Alan Chase won 2, Ted Birch 1 and Alan and Ted winning the doubles for the YM's first team. East Wavertree 'A' v Wavertree Lab. 'A', result not yet in.

The season is going along very well and we are extremely fortunate to be playing with such talented players who are very sporting, each week they turn up, as do their opponents, some less talented, but also give their all in the most sporting way. Can I thank you all for your company and efforts.

## Division 3.

## Ian McElwee

**Wavertree Labour C** have continued their fine form into the 2<sup>nd</sup> half of the season acquiring 100 points from their 13 matches. In the 6 matches during the reporting period Lee Farley, Mario Giove and Richard Wan have been ever present (in fact they have only used a reserve in 1 match this season). Such consistent availability brings consistent form and they have beaten Arriva NW A 10/0, St Anne's and Linacre 9/1 and CADWA A 6/4 in recent weeks. In the CADWA match Lee was unbeaten but Ian Wensley and Paula Adamson each beat Mario and Richard, Paula came close to beating Lee winning the first 2 games comfortably but Lee kept his nerve and took the final 3 games 13/11, 11/9, 11/9. When visiting Maghull B they were thankful to Richard who won his 3, Maghull's Phil Christie came away with good wins over Lee and Mario. Their only loss to date was in going down 8/2 to BSM D at week 13.



**Maghull B** lie in 2<sup>nd</sup> place on 92 points having won 10 and drawn 3 of their 13 matches, are they capable of remaining unbeaten to the end of the season? They have beaten Sefton Park and St Anne's 9/1 with Robbie Puddifer hanging on to beat John McLoughlin Junior 15/13 in the deciding game to gain Sefton Park's sole point, Israel Isaac was the point winner for St Anne's with a 4 game victory over Alan Chan. They continued on their way with 8/2 wins over CADWA B and a 2 man Merseyside Police C, Tom Purcell played to the top of his form earning an 11/8 5<sup>th</sup> set win over Susie Hughes, Ruben De Antonio Liedo earned the Police their other point beating John Langton in 4 games. As reported earlier they drew with table topping Wavertree Labour C and must have been fairly confident when BSM C visited at week 14, Phil was again in top form, and John got the better of Ted Cramsie and Dave Noden, BSM C number 1 Darren Taylor gained



an 11/9 5<sup>th</sup> set win over John, beat Alan Chan and combined with Ted to take the doubles, BSM took a further 2 points to secure a draw with wins for Ted and Dave over Alan Chan.

**BSM D** hold onto 3<sup>rd</sup> position, 2 points adrift of Maghull having played 2 additional matches, the team have been hit by the loss of Ula Kuczak who has not been available in recent weeks due to work commitments. In the main, reserves coming in for her have, understandably, not picked up a great number of points, of the 7 matches played during the period under review we have won 2, drawn 2 when facing Linacre and Merseyside Police C, and had a series of losses to CADWA A and B and Bootle YMCA B by 6/4 score lines and a 9/1 battering by the club's C team when Ray Hibbs saved face in obtaining a win over Graham Turner. Fred Bainbridge came in as a reserve for the Wavertree Labour C match, Fred and I won our singles and Les Dodd beat Mario and Richard. We were unable to obtain a reserve when facing Sefton Park but Les and I won on each visit to the table to secure a 7/3 win.

**BSM C** have had an excellent start to the 2<sup>nd</sup> half of the season and are 4<sup>th</sup> in the division on 87 points, they have a well balanced side and during the period under review they have remained unbeaten, winning 4 matches and drawing 3. Their best win had to be the aforementioned victory over their club's D team, the D team had a couple of reserves out but all credit to the C team for playing so well on the night. In an 8/2 win over Arriva NW A Ray Hibbs and Ted Cramsie both won their 3 singles with Dave Noden getting the better of Gary Stanton and combining with Ted to take the doubles. In another 8/2 win when they faced Linacre, Dave was back to top form winning his 3 singles and combining with Ted to win the doubles. In addition to their well earned draw at 2<sup>nd</sup> placed Maghull B they have drawn with near rivals CADWA A and Merseyside Police C.

**CADWA A** are in 5<sup>th</sup> place on 82 points from 14 matches, a strange situation occurred in their draw at BSM C, BSM C fielded 2 reserves whilst CADWA A only had Ian Wensley and Martin Latham available, Ian got the better of Dave Noden and Ray Hibbs, Martin beat Dave and Ned Hassam and this pair took the doubles 11/7 in the deciding set. They had a resounding 8/2 win over bottom of the table St Anne's, for whom their captain Dave Bradley injured himself sitting down after his pre match warm up and was literally unable to get out of his chair for the remainder of the night. Israel Isaac played well for ST Anne's beating Martin Latham and Alan French. In other matches they have consistently picked up points beating the Police side 7/3 and a 2 man BSM D 6/4 whilst gaining that respectable draw at BSM C, and a further draw when facing Linacre. Peter Wass was MOM in the win over Police C, remaining unbeaten on his 4

visits to the table. Ian Wensley beat Mick Winder and John Moore, with Martin also getting the better of Mick and supporting Peter in the doubles win.

The **CADWA B** team certainly have sufficient talent available with Ian Burrows, Paula Adamson, Alan French and Vaclav Holcman as proved by their 6 wins and 2 draws from 13 matches. They had an excellent night when they came out 6/4 victors over their A team, Ian and Alan beat Martin Latham and Alan Evans, and Vaclav beat Ian Wensley in 4 plus beating Alan. Another 6/4 win came against Linacre when Paula replaced Ian and played particularly well to win her 3 singles, and partner Vaclav in their doubles win, Alan and Vaclav both beat Sunil Sapre to clinch victory.

7<sup>th</sup> placed **Sefton Park** have 58 points from 14 matches. In recent weeks they have beaten CADWA B and Arriva NW A by 7/3 margins plus securing draws against St Anne's, Police C and Linacre. They were helped in the CADWA B match when only Alan and Vaclav were available to compete but Robbie Puddifer beat both, and partnered Ian Findon to take the doubles with Chris Greaves beating Vaclav. Robbie continued his fine form to take his 3 singles in the win over Arriva NW A, as did Chris Greaves with Ian contributing with a 5 set victory over Gary Stanton. There is no way of keeping Robbie out of the lime light as he again won his 3 singles against Police C, including a 13/11 5<sup>th</sup> game win over John Moore. Chris also had a hard fought 11/9 5<sup>th</sup> game win over Dave McMahon and defeated John to make up the 5 points.

8<sup>th</sup> placed **Arriva NW A** are 1 point adrift of Sefton Park, they have beaten CADWA B and St Anne's 6/4 and Linacre 7/3 during recent weeks. Eddie Williams is having a good season, picking up points on a regular basis, he had a particularly good night in the defeat of Linacre remaining unbeaten in his singles and partnering Gary Stanton to win the doubles. Wacek Bondek beat Charlie Bradshaw and Sunil, and Gary also beat Sunil to secure the win. In a close fought encounter with CADWA B Eddie beat Ian Burrows and Alan French, Wacek beat Ian and Alan and partnered Eddie in an 11/9 deciding game win in the doubles, Gary played well to beat Ian, walking a tightrope before taking the 5<sup>th</sup> game 12/10.

Again only 1 point separates **Merseyside Police C** from Arriva, with Bootle YMCA B a further point behind in 10<sup>th</sup> place. The Police side achieved important wins over Arriva 7/3, and Bootle YMCA 6/4. The team changes from week to week but it was Brian Burrows, John Moore and Ruben Liedo who were on duty against Arriva, Eddie Williams won his 3 singles but that was as good as it got with the Police winning the remaining sets. Dave McMahon and Mick Winder joined John for their victory over Bootle YMCA, Mick earned the MOM award remaining unbeaten on the night, winning all his matches in the 5<sup>th</sup> game, including an 11/9 final game win over

Eddie Preston, Dave and John both beat Bert Rivers and combined to win the doubles.

**Bootle YMCA 'B'** have a couple of matches in hand over their rivals and if they continue to perform as they have in recent weeks should climb up the table. They have been on a good run winning 6/4 against BSM D, Arriva NW, St Anne's and Linacre. Richie Winkle was in form in the win over Arriva NW A winning each of his singles comfortably, Burt had to fight all the way against Eddie Williams, finally winning 9/11, 11/9, 11/9, 8/11, 10/12, he also beat Yanusz Wator with Eddie Preston beating Wacek Bondec.

**Linacre** are finding it hard going and have yet to record a win from their 15 matches, however, they pick up points most weeks and remain in contention with teams above them. Alex Charcenko was in brilliant form when winning his 3 singles against a full strength BSM D, Charlie Bradshaw had a good 11/9 deciding set win over Ula and followed this up to beat Les Dodd. Alex repeated his 3 wins when they faced CADWA A with Charlie again offering his support with victories over Martin Latham and Alan French. This is turning a little repetitive but Alex again won his 3 when Linacre went down 6/4 to Bootle YMCA B, their other point came via Harry Nelson who beat Eddie Preston 12/10 in the deciding game.

## Division 4.

We are well into the season now, and at the time of writing these notes QVC are performing a "Manchester City" style assault for the 4<sup>th</sup> Division title with a lead of 31 points over current 2<sup>nd</sup> place Wavertree Labour D, they have a very strong squad who have turned out regularly, which makes them very consistent. It's quite close behind QVC with only 9 points separating the 2 Wavertree teams, Waterloo and East Wavertree.

**Week 9** starts us off with a draw between Maghull C and Waterloo, good night for young Luke C winning his two for Maghull and Graham C also picking up two for Waterloo. East Wavertree beat Bootle YMCA C 6-4, which considering their current league positions was a reasonable result for Bootle, John T enjoying a good night, picking up his two games for Bootle, Joey W doing the same for East Wavertree. The Sefton Park derby between C and B saw B coming out winners 7-3, both Neil J and Alan S winning their 2 games for the B Team. Wavertree Labour E ran out victors 8-2 against my own team Sefton Park A, Kenny Y picking up a single and then partnering Alan S for Sefton's 2 points. Hard fought match between Waterloo A and Wavertree Labour D, Wavertree winning 6-4, only 2 sets here going to 3 games, Steve J picking up 2 for



## Ken Roberts

Although bottom of the table with 50 points from 14 matches it has not been all doom and gloom for **St Anne's**. When they went down 6/4 to Bootle YMCA, six sets went to 5 games, Israel Isaac won each of his singles in the 5<sup>th</sup> game and partnered Dave Bradley to win the doubles. Israel has a fantastic forehand hit and when he gets it on you are lucky to see the ball as it flashes past you, like Alex above, he has a habit of winning his 3 singles, doing so in a 6/4 defeats to BSM C and Arriva NW, and when his team drew at Sefton Park. In the Sefton Park match Dave Bradley beat Ian Findon and partnered Israel to win the doubles.

In summary it looks like Wavertree Labour C will hold onto their lead to win the division, and with matches in hand over BSM D, Maghull B will finish in 2<sup>nd</sup> place. There is not a lot between most of the other teams, and the lower half of the division is so close there are likely to be changes in position on a weekly basis to the end of the season. Linacre and St Anne's look like favourites to go down, but I would not be surprised if either of them climb out of the bottom 2, particularly bearing in mind the form of Alex and Israel for their respective clubs.

Wavertree here, and a good win for Sean C of Waterloo over Robin B, Phil O'M also winning a brace for Waterloo. An excellent win for Bath Street Marine E, and a rare defeat for QVC, Bath Street winning 7-3, Peter Ash having a good win over the strong Panchu for Bath Street on the way to picking up both of his games, Andy A also winning both his sets for Bath Street.

Back on their winning ways for QVC in **week 10**, beating Maghull C 7-3, QVC having the unbeaten Andy C back for this one. Luke, Julian and Danny winning one each for Maghull's points. Close game between Sefton Park A and Waterloo A, Waterloo winning 6-4, John G producing another strong performance winning both for Sefton, Phil Cash winning both for Waterloo, including a close 5 game against Bobby B. Wavertree Labour D were too strong for Bootle YMCA C with a 7-3 win, Steve D and Mike H winning one each and a doubles win for Bootle's 3 points, Steve J and Richie P winning a brace each for Wavertree. East Wavertree also beat Sefton Park B 7-3, Neil J, Alan S and a doubles win for Sefton's 3 points, my old Marconi team mate Paul Lof picking up his two for East Wavertree C. Bath Street Marine E beat Sefton Park C 6-4, which was a good result for Sefton Park because they played short on the night, Paul J picking up a brace for Sefton.

All square between Maghull C and Bath Street Marine E in **week 11**, Nedim H winning a brace for Bath Street including a marathon 5 game against Luke, winning game 9 in the 5<sup>th</sup>. Sefton Park A beat Bootle YMCA C 8-2, Steve D and a doubles win providing the 2 points for Bootle. East Wavertree beat Sefton Park C 7-3, Jimmy W and Paul L winning 2 each for East Wavertree, Jamie W, Shan Lu winning a game each plus a doubles for Sefton's 3 points. Waterloo were too strong for Wavertree Labour E winning 8-2, Alvin T and Ming R providing Wavertree's 2 points.

**Week 12** kicks off with a win for Maghull C over Sefton Park C 6-4 both Janette and daughter Amy picking up a brace each here for Maghull C. QVC beat Wavertree Labour E 7-3, Jason Ao winning one and David Ao picking up his two games for Wavertree's 3 points. The derby between Sefton Park A & B was won by the A team 8-2, Paul M beating Richie P and a doubles win for the B team's 2 points. In the Waterloo derby, the first team were victorious over the A team 7-3, Sean C was the star for the A team winning both of his games, supported by Gary C for the A team's 3 points. All square between Wavertree Labour D and East Wavertree C, Paul L and Jimmy W winning their games for East Wavertree, my old team mate Gordon Lang just losing out against Ged game 9 in the final game which would have given a win to Wavertree.

Waterloo overpowered Bootle YMCA C 9-1 to start a New Year and **week 13**, Mike and Jim teaming up in the doubles and rescuing a point to save the whitewash. Wavertree Labour D beat Sefton Park C 7-3, an excellent double for Jamie over both Robin and Terry and a win for Kenny supplying Sefton's 3 points. Wavertree's E team registered the same score, beating Bath Street Marine E, Peter A and Tony B plus a doubles win providing Bath Street's 3 points. East Wavertree C beat Sefton Park A 6-4, originally it was 8-2 on the night but unfortunately East Wavertree played a player who had been reranked and was ineligible to play that night. QVC were too strong for Waterloo A winning 8-2, Gary C and a doubles win providing Waterloo's 2 points.

**Week 14** began with a 6-4 win for Bath Street Marine E over Waterloo A, Phil O'M winning a brace here for Waterloo as well as Jeff H winning a 5 game epic against Graham T, Sam P having an excellent night with a double for Bath Street Marine E. Wavertree Labour D won well against Sefton Park A 8-2, John G and a doubles win supplying Sefton's 2 points. QVC whitewashed Bootle YMCA C with a very convincing performance. Waterloo beat Sefton Park B 7-3, Neil J, Kenny Y and a doubles win providing Sefton's points, Dave C and Pete R providing an excellent game with Pete R winning in 5 games. A very convincing performance by Wavertree Labour E beating Maghull C 9-1, Janette H saving the whitewash with a good win over an evergreen Biggsy.

QVC beat Sefton Park B 7-3 to start **week 15**, an excellent brace for Kenny Y and a doubles win for Sefton's points. Good win 6-4 for Maghull C over Waterloo A, Luke C and Danny H winning a brace each here for Maghull. The derby between Sefton Park A and C resulted in a win for the A team 6-4, some long hard-fought games in this one. Patricio R picking up two for the C Team. All square between Waterloo and East Wavertree C, Jimmy and Joey Williams picking up a brace each here for East Wavertree. Bath Street Marine E over powered and whitewashed Bootle YMCA C.

Wavertree Labour D beat Waterloo 6-4 to start **week 16**, a hard fought match with only 2 sets finishing in 3 games, George L winning his two games for Wavertree and Paul M replying with a double for Waterloo. Bath Street Marine E beat Sefton Park B 6-4 another hard-fought match here, Neil J winning both for Sefton and Tony B doing the same for Bath Street. Same score between Bootle YMCA C and Maghull C with Maghull taking the spoils, the evergreen Lenny D winning his two for Bootle and Luke C obliging with two wins for Maghull. Wavertree Labour E were too strong for Sefton Park C winning 8-2. Kenny Y and Patricio R supplying a win each for Sefton's points. Two teams in the top four provided a great game, with QVC beating East Wavertree C 7-3, Ged H winning a brace for East Wavertree along with a single for Lawrence C. Andrew C and Panchu X winning both of their games.

**Week 17** saw a drawn game between Bath Street Marine E and East Wavertree C, very close game here, Graham T picking up both of his games for Bath Street and Jimmy W doing the same for East Wavertree. All square between Waterloo and Sefton Park A, John G again picking up a brace for Sefton and Jeff H doing the same for Waterloo. Maghull C were too good for Sefton Park B, winning 9-1, Neil J saving the whitewash with a win over Janette H. Wavertree Labour E beat Waterloo A 7-3, Phil O'M, Gary C and Mark B all winning a single each for their 3 points. QVC had a walkover against Wavertree Labour D.

**Week 18** saw QVC beat Sefton Park 6-4, John G winning both again and yours truly taking the other single game for Sefton, Ian D winning his two games for QVC. All square between Bootle YMCA C and Wavertree Labour E, Jason Ao winning his two for Wavertree and Lenny D obliging again for Bootle. East Wavertree C beat Maghull C 6-4. Jimmy W and Ged H picking up 2 each for East Wavertree. Titanic struggle between Wavertree Labour D and Bath Street Marine E, culminating in a draw, Graham T picking up 2 for Bath Street, including a 5<sup>th</sup> game victory game 10 against Robin B, Steve J also winning a brace for Wavertree. Waterloo A beat Sefton Park C 8-2, Jamie W and Patricio R picking up Sefton's points with a win each.

it's still all to play for in Division 5 and questions aplenty. Can anybody stop the seemingly unstoppable Waterloo? Which team are going to be the main challengers? Can anyone defeat the unbeatable Rod McPherson and Eddie Clein up at Harold House? Which of the Maghull teams will finish the highest? Can the young guns at Wavertree Labour F continue to improve? And can Bath Street Marine F secure a first win of the season? So for all you bloggers, vloggers and old codgers this is the mid-season report.



Wavertree Labour F beat Harold House 6-4 in a thrilling contest, Eddie Clein won his matches as ever but the stand out performance was Ming Rong's thrilling 3-2 victory over the experienced and previously unbeaten Rod McPherson, Ming looks a real prospect and could go far. Sefton Park D beat a weakened Bath Street Marine G 8-2 and are now one of the hardest teams to beat in the league.

## Match Week 12

Greenbank B edged out Bath Street Marine G 6-4, it was nip and tuck all the way but Nicholas Cox secured his first win of the season over Des Logan in a high class encounter, Alby Ofoeme was the stand out player on the night but Barbara Alcock showed all her skills in both the singles and the doubles, a delightful display. Wavertree Labour F continued their form from the previous week by beating Bath Street F 9-1, Ming Rong once again took the plaudits but Gobinath Sivanesan had two comfortable wins and is fast improving. Waterloo B had to be at their best to beat Maghull E 9-1, but there were some close fought matches, Mark Brooks caught the eye and looks a much improved player up at Waterloo. Sefton Park D beat Maghull D 7-3, there was a guest appearance from the skilful Amy Hutchings and she had a good night.

## Match Week 13

Maghull E and Harold House drew 5 all, Rod and Eddie won both their matches, but Brian Gregory was the best player on the night, comfortably winning his matches in some style. Arriva B showed all their experience in overcoming Wavertree Labour F 7-3, Harry Hughes was back to his best with two hard fought victories, but this was a tough assignment for the bus drivers. Bath Street Marine G got a great draw with Wavertree Labour G, the young Mason brothers were very solid but it was Francis Lay's five set victory over Hugh Frediani-Bellis that will live long in the memory, what a comeback! In a delayed match Greenbank B beat Maghull D 7-3, a surprise result given the respective league positions, Tim Ainsworth out hit his opponents with a virtuoso display and took P.O.M. he looks to be running into some form.

## Match Week 14

## Match Week 9

The week started with a top of the table clash, Waterloo were once more on imperious form and made light work of Arriva (8-2), Geoff Metcalf was the pick of the players and he continues to have a fine season. Maghull E and Sefton Park shared the spoils in a great match, Shan Lu and Chris Halliday have strengthened the Sefton Park team and this is starting to show in their results. Wavertree Labour F edged out the G team by 6-4 in a super match, there were close matches all through the card but Zhixuan Yan was P.O.M., Harold House had far too much for Bath Street

## Match Week 10

Arriva beat Harold House 8-2, Ray Guy led from the front with 2 wins and Edward Harrison is one of the best number 4's in the league and is always hard to beat. Greenbank B lost out to Maghull E 4-6, though a certain Simon Craske ended Joseph Rock Jnr's 100% record. Good to see the Bruce family playing together and Dad Ali winning a five setter against the tricky Kevin Hazard, but Andy McCourt proved to be the difference between two closely matched teams. A weakened Maghull D still had too much for Bath Street Marine G, winning 6-4, and Waterloo took apart Wavertree Labour F 9-1, though the match card suggested a much closer contest.

## Match Week 11

Arriva B easily beat Bath Street Marine F 10-0. There was a great game up at Maghull where the E team drew with Wavertree Labour G, Gordon Langshaw was the only player to win both of his matches and on his night can beat anyone in the league.

Maghull D just beat an understrength Wavertree Labour G 6-4, Maghull were strengthened by the appearance of Julian Dutch who is very solid, Dave Williams had his best night of the season and got the brace, in my humble opinion he is also one of the best doubles players on the circuit and his partnership with Eric Spencer is a strong one. Maghull E were far too good for Bath Street Marine F winning 9-1. Waterloo B also beat Bath Street Marine G 8-2, Chris Jago got two good wins but a word about Euan Mason who won both his singles against tough opponents and is one of the best junior players in Liverpool, keep it up Euan! Finally Sefton Park D beat Greenbank B 7-3, the match was played in good spirits with Tony Low taking player of the match. Colm Cox is looking good again and is taking his undoubted talent into the matches, he beat the tough Chris Halliday in three straight.

### **Match Week 15**

Harold House beat Bath Street Marine G 9-1, but the score doesn't tell the whole story as there were some close matches. Arriva B beat Maghull E 6-4, this was a close encounter and it was the doubles play of the Arriva boys that was the difference, Gary and Ray held their nerve and beat Andy and Brian in a 5 set nail-biter. Sefton Park D go from strength to strength, this week they beat Wavertree Labour G 7-3, Paul Jennings is proving to be unbeatable at present and there is a confidence about this strong squad that is impressive. Finally Waterloo beat Maghull D 7-3, there were some good matches all through the card but young Nathan Jago was the stand out player on the night and is getting better and better. Once again it was double Dutch for Julian and his victory over Phil Cashmore was one of the best matches on the night.

### **Match Week 16**

Harold House continue to impress with a 6-4 victory over Maghull D, Rod and Eddie won their matches but these are two closely matched teams with some tough players. There was nothing to separate Greenbank B and Wavertree Labour G, those wise old heads at Wavertree Labour got their acts together in the crucial doubles, winning both, and secured the draw. In a surprise result. Wavertree Labour F pipped Maghull E 6-4, this team seem to be getting better as the season goes on. Bath Street Marine G beat their compatriots the F team 9-1, with Stephen McCormick back to his early season form. And in one of the matches of the season, there was nothing to separate Sefton Park and Waterloo, just about everyone

played well, a credit to the quality of play in the Division this season.

### **Match Week 17**

Sefton Park D just beat Harold House (6-4), the match was noteworthy for the straight sets win by Chris Halliday over Eddie Clein, who lost his 100% record, well done Chris, but also well done Eddie for staying unbeaten for so long, 21 straight wins is no mean feat. Arriva B proved too strong for Bath Street Marine G, winning 8-2. Waterloo were back to their best beating Greenbank B 8-2, Tony McDonald smashed his way to two confident wins, and Peter Walsh Snr showed us all what a good player he can be, although it is unclear whether he is better with his left or right hand! Maghull D cruised to victory over Bath Street G with Denise Chorley looking the outstanding player on the night with comfortable victories.

### **Match Week 18**

Arriva are on a fine run, this week they beat Maghull D 8-2, Julian Dutch continued his fine late season form but Arriva were just too sharp. Greenbank B beat Harold House 6-4, Peter Walsh Snr showed his experience with two fine wins, his comeback in the fourth game against Stephen Simpson proved pivotal, Peter is a player for whom the game comes naturally and he has a style all of his own. There's no stopping Waterloo, this week they beat Wavertree Labour G 9-1, each Waterloo player is very high up in the averages and they really have had a great season. Finally in the kids shoot out, Wavertree Labour F just beat their young rivals from Bath Street Marine G 6-4, Gobinath Sivanesan was the best player on the night, however all of these players, if they keep practising, will feature in higher leagues in years to come. But it is a credit to both clubs that they are investing in young talent and giving them the chance to compete in the league, hope it wasn't past their bedtime!

### **Conclusion**

Waterloo B ook to have secured the title barring a complete collapse, but hats off to Sefton Park D and Arriva B for putting a great run of results together. But I think the final word should go to Bath Street Marine F, a great club and some friendly players up there, but whilst they have struggled, they have never given up and their determination and resolve which should be a lesson to us all, well done Bath Street F and indeed well done to everyone for doing their best and playing to a standard which makes this Division one of the best in the North West.

## Jack Hunter - Spivey will be remembered at Sefton Park T.T. Club



### Jack On The Podium in Las Vegas

Jack Hunter-Spivey produced a superb performance in Las Vegas to win gold in the men's class 5 singles, defeating the world champion in the semi-finals and the London 2012 Paralympic champion in the final.

Leeds University medical student Kim Daybell took silver in men's class 10 and 17-year-old Welshman Josh Stacey took bronze in men's class 9.

Hunter-Spivey won his two group matches against Ahad Bakshaei Sarand from the USA and the Dutchman Gerardus Van Grunsven 3-0 and reached the semi-finals with a 3-0 win against the American Stuart Caplin in the quarter-finals.

The 22-year-old from Liverpool reached the final with a 3-0 win against world champion Valentin Baus from Germany and then clinched his first individual gold medal with a 3-2 win against his great friend and regular team partner Tommy Urhaug, the former Paralympic champion from Norway.

**Author:** Francesca Bullock **Publish date:** December 18, 2017

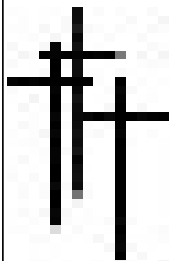

*It is with regret that I have to report the death of Eric Ferguson, 85 yrs.*

*Eric played for the Police TTC for many years up until the mid 1980s, he was a well known character at the time and was a left handed pen-holder. After retiring from the police Eric moved to Knaresborough in Yorkshire and played table tennis in the Harrogate League.*

*He and his wife moved back to Liverpool in March 2017 to be nearer their family but sadly Eric passed away on 25th November 2017*

*Tom Purcell  
L&DTTL Secretary*

10 year old Louis Cheung-Turner who has just been ranked number 1 in England U10's.

Louis started at St John's After School Club when he was 7. Although he's still a member of St Johns TTC, he attends Halton TTC 3 times a week . Louis presently plays for St Johns in the JDD.



I can't recall the last time Liverpool had an England number one.

*Paul Gittins - J.D.D. Secretary*

## Bath St. Marine Secretary receives Volunteering award from City



Graham with his award and that "what, me!" look of surprise surprise

One of the factors that makes Bath Street Marine Table Tennis Club a vibrant and successful club is the quality of the volunteers who help to run it! It is important to recognize and celebrate those who give their time and efforts to ensure that something works to the benefit of all. As a club we are truly blessed by a splendid band of volunteers who 'make it happen' at Marine. Our volunteers include our Management Committee, our team captains, our social organizers and fund raisers, those who make the tea, and those that look after the maintenance of our table tennis room. Without such a wonderful band of helpers the club simply wouldn't function.

On Monday last, Club Secretary, Graham Turner, was attending the inaugural City of Liverpool Sports and Physical Activity Awards evening, at St George's Hall in Liverpool. The event was arranged by Liverpool City Council and Liverpool Sports Forum to celebrate achievement in sport and physical activity and the role which volunteers play in promoting, encouraging and supporting sport and physical activity. You should have seen his face when it was announced that he was being awarded the 'Volunteer of the Year' award in connection with his participation in Bath Street Marine TTC and table tennis at the Anfield Sports Centre!

In announcing the award, Chairman of the Liverpool Sports Forum, Stuart Wade, said

*"Graham is an avid table tennis player, and is very involved with Bath Street Marine Table Tennis Club. In Ping! Liverpool's 2016 summer festival, Graham came on board as a volunteer. He was a very active volunteer and attended every event Ping! Liverpool held. Ping! Liverpool's Summer Festival may have finished, but Graham had only just started. In addition to being heavily involved with Bath Street Marine Table Tennis Club Graham attended the adults social session at Anfield Sports and Community Centre, encouraging a large number of participants to attend; helped the delivery staff with setting up equipment, recruitment of participants and taking registers. His help didn't stop there - he then heavily supported a newly established Junior League successfully run on a bigger scale than it ran in its previous year. On the back of Graham's support, it built capacity in ASCC's staff team to start a Junior Table Tennis Club for Under 16's which now attracts approx 20 young people each Friday night which now has 8 young people in the Liverpool and District Table Tennis League Junior Development Division, none of whom have ever played competitive table tennis before. Finally, he initiated an adults Monday night social session to keep table tennis players ticking over during the summer while the League had a summer break, and also to secure the venue booking for the start of the next Liverpool Junior League season. Graham returned as a volunteer to Ping! Liverpool's Summer Festival in 2017, again attending all the events to support Ping! staff, promote the benefits of table tennis and fully embodied the spirit of Ping! More recently, Graham has had a hospital stay, due to heart trouble and was out of action from playing for some weeks, but has used the volunteering and assisting coaching as part of his rehabilitation and is now on the road to full recovery. Graham's commitment has never wavered."*

On hearing such comments, the shock on Graham's face was obvious! Despite the slight embarrassment there is no doubt that it is a great encouragement when there is recognition of voluntary service. The whole evening gave a great insight into the tremendous work of so many people who volunteer their time to encourage and develop their sport or physical activity, and it was really good to see this being recognized and celebrated.

At Bath Street Marine TTC we are proud to acknowledge and celebrate all of our volunteers. It is their efforts that 'make it happen' at Marine week by week.



# Lawrence Kenwright

M.D. Signature Living - former 1st team player Liverpool YMCA T.T. Club, presently with the Greenbank T.T. Club



The 2003-04 Liverpool YMCA team which won the Div. 1 Readman Cup, - Omid, Peter, Lawrence & Keith

## Homeless and Rough Sleepers around the City Centre

Article in the Liverpool Echo 12<sup>th</sup> December 2017.

The hotel developer opened up the Kingsway House building, in Hatton Garden, last week and said he has been "overwhelmed by the demand". Mr Kenwright said the entire ground floor of the building (The Kingsway House in Hatton Garden) will now be opened up for rough sleepers - with a special area dedicated to those with pet dogs. In a statement, he said: "I was reluctant to talk to the media about the support we're providing for the homeless, simply because this was never intended to be publicity exercise. "However, given the immense public interest and support for the scheme, it is important to explain why Signature Living is taking action.

"Anyone who walks around the city centre will see the plight facing the hundreds of people sleeping on the

streets. "It is a situation that breaks my heart and it is visibly getting worse." In Facebook comments over the weekend, Mr Kenwright accused the city council of trying to "close down" the centre - but speaking last night he made it clear he wants to support the authority in its work. He said: "Liverpool City Council and great charities like the Whitechapel Centre are doing what they can to help. They've got my full support. "But, in the bitter cold of winter, they can't do it alone. I have a building that won't be used by my company until the New Year, so I've opened it up to provide hot food, shelter and a bed for people who have no place to call home. "The shelter has now been open for 72 hours. I have been overwhelmed by the demand. "Last night, 55 people stayed with us. I expect the number to reach 100. "As a result, I have decided to expand the facilities available to the homeless. We are opening the entire ground floor of the building and are providing a quarter for homeless people with dogs, too." The team running Kingsway House will also open up the building's car park and launch a car washing service - which Mr Kenwright said will be managed by homeless people - with money earned going to the running of the centre. He added: "Some of these people have complex needs and I accept that I do not have all the answers. But look at the problem that faces us here in Liverpool: we can't sit back and do nothing. "I have been astounded by the support from members the public who have rallied around with donations of food and clothes. "It is incredible what we have achieved in a short space of time. "We know in this city that, when we unite, we can remedy even the most difficult of challenges. "There are those who will criticise. My message to them is simple: human compassion is a necessity, not a luxury."

**By LIAM THORP Politics Reporter**

liam.thorp@trinitymirror.com. @LiamThorpECHO

## The Future of Croxteth Hall

Lawrence Kenwright -Facebook - 13 February 2018

Lawrence has opened his Facebook page to public debate, "our Council can no longer keep paying the costs to run this Hall, in fairness to them they have got to make £30 million pounds worth of cuts a year for the next three years and this building has cost as much as £2.5 million pounds a year to run and at a time of extreme austerity I do believe there are better places for this money to be given.

I also believe that this building would be best served by using it as a Hotel, people from all over the World can then sleep within the halls of this great house, just like the Dukes and Duchesses before them. We will not alter any of the museum aspects or the tours that have been created, what we will do is ensure that we put a social beacon on the roof so that people feel the desire to see this amazing building and what it offers.

As you know signature Living, have become the largest hotel operator in our City, by simply telling stories of our heritage, can you imagine just how many jobs and tourism we will create with an Iconic building such as Croxteth Hall



This is an asset that should always be owned by the people of our City, if we are chosen along with our partners the Alt Valley Community Trust, we will just be the operators of the hotel and we have asked for just a 5 year term. If the people of our City like what we are doing then we will ask for it to be extended. Everyone will be able to use the grounds in exactly the same way that they do today, apart from the added security that a 24/7 Hotel would bring.

Signature Living, also wish's to gift 33% of all profits to our local communities which I believe after year two will be in excess of 500k per annum, these funds will help the more vulnerable of our society.

Our Council are here to reflect what you the people want, and if that is not Signature Living, then that is fine, but what we need to do is stop wasting a very rare commodity, our Cities money.

For once let's create an open debate and gain openness and transparency, if you do not like what we want to do please tell us, but likewise if you think this is a great solution please state what you feel. Please hit the share button and leave a comment.

Come on guys, let's debate and help our Council make a decision, which has to be made in February 2018 "

What's that I hear! that's not Table Tennis, it's politics, a dangerous subject, but considering that Lawrence's Signature Living seems to have a good record of ' helping to Save the City's heritage ' via refurbishing historic buildings rather than allowing them to decay.

But is Croxteth Hall 'a bridge too far'? as he may have a battle on against the City Council. A case of "Watch This Space"

An offer of ploughing a lot of money in for a short term lease probably one of those projects which are ' too good to be true ' and with so many covenants and heritage requirements, easier said than done!!

Can we wish Lawrence ' Best of Luck ' in his endeavours? Editor.

## Bath Street Marine Table Tennis Club

MARINE FC has revealed plans to upgrade its Crosby stadium with a new snack bar, club shop, kit store and supporters hospitality room.

A planning application has been submitted to Sefton Council For permission to carry out the work to the Marine Travel Arena, on College Road. To help meet the costs, club officials have launched a Ground Appeal to hit the £35,000 target, with £13,000 already raised so far.

If the council approves the proposal, the existing old timber building, which was originally built in 1929, will be demolished to pave the way for a 'remodelling' of the facilities behind the main stand at the College Road end of the ground.

Marine F.C. have reached an agreement in principle with **Bath Street Marine Table Tennis Club**, which will see them accommodated elsewhere on the ground, subject to them obtaining the necessary funding and planning

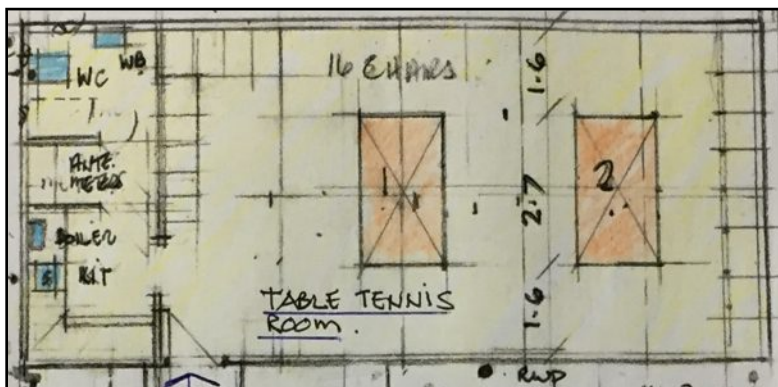

The proposed layout of the the new Table Tennis Room will be via 6 standard Site - Office containers with an estimated match playing area of 40 ft x 19 ft x 7'-8" high . n.b. for a comparison Bootle YMCA's T.T. room measures 42 ft x 21 ft. so space for the defenders to get 'back! and should be easier to keep warm with good insulation to stop the building 'sweating'

permission, which will be submitted in a separate application.

"Subject to obtaining planning and the necessary funding we intend to carry out the scheme during the 2018 close season."

Marine F. C.

More info can be found on BSM TT Club's excellent web site at [Bathstreettabletennisclub.org](http://Bathstreettabletennisclub.org)

Having recently posed for a selfie with my brother Stephen outside the West Ham Olympic stadium, it's difficult to comprehend how such an impressive structure, set in the glorious surroundings of the Olympic park, could evoke such controversy amongst its fans. Thankfully, it wasn't a match day, it was however a very bitterly cold Thursday morning and once we had captured the photographic keepsake, we turned a sharp right and headed towards the equally famous Copper box stadium, this being the venue for the ITTF World Team Championships.

Having selected our seats and settled down to watch the World's best, I was initially concerned with what appeared to be a poor turn out of spectators, I feared that the empty seats would inevitably lead to a lacklustre atmosphere. I couldn't have been more wrong, within the hour over 1500 school children were shepherded into the stands taking advantage of TTE's community policy of providing free tickets to local schools. The children whom I'm sure were totally ignorant of all table tennis matters, eagerly awaited the entrance of the two teams who were scheduled to play on the nearby table. What happened next was I'm sure more out of luck than design, it just so happened that this was the table now occupied by Japans 14 year old sensation Tomakaru Harimoto. The teenager soon delivered a display of pure energetic brilliance, screaming and fist pumping after every point, the young spectators lapped it up. "There's only one Harry Moto" soon echoed around the arena.

I could obviously appreciate the extraordinary table tennis talent of the world's number 13 but what was more remarkable was the reaction and enthusiasm of the school children who fully embraced the occasion and were totally absorbed by our wonderful sport. Within a matter of minutes of Japans victory all the public practice tables were quickly occupied by scores of children eager to emulate their new found hero, how fantastic would it be to harness that enthusiasm and provide the opportunity for youngsters to play table tennis in a competitive and fun environment.

Our very own L&DTTL Junior Developmental Division (JDD) is slowly but surely providing that opportunity, for the past three months 50 youngsters, aged between 7 and 15 years old, have been competing in two divisions every Monday evening at the Anfield Sports & Community Centre it is no exaggeration to say that every Monday at least on one occasion when one or two matches have received standing ovations from the entertained spectators. The trend started in week one when Crosby High 'F' Charlie Williams and Joseph Dixon faced Crosby High 'G' Maddox Graham and Michal Johnson in the end of match doubles games, Charlie and Joseph coming back

from 5-10 down to secure the win 13-11, what a fantastic match, all four youngsters were under 10 years old and finished the match shaking hands and with exuberant smiles.

It soon became evident that the contest to lift the 'Bill Fawley' first division title was to be a closely fought battle, Anfield 'A's James O'Dwyer has only suffered one defeat all season to the hands of Crosby High 'A's Louie Cooper, James O'Dwyer's partner Dominic Birkbeck also sustained a high winning percentage having only suffered 5 defeats. It was left to the Marine 'B' duo Finn Mason and Hugh Frediani-Bellis to push the Anfield team all the way to the final week of play. At the conclusion of the league fixtures both teams finished with 109 points, this resulted in the teams previous 'Head to Head' encounter deciding the fate of the title and lead to Anfield 'A' being crowned as first division champions.

A closely fought contest also prevailed to secure the 'Arthur E. Upton' second division title, Crosby High 'F' consisting of Charlie Williams and Joseph Dixon secured the title on 124 points but were closely pursued by Andrew Kearney and Oliver Stanyer-Jones of Crosby High 'I' who finished the season on 115 points. When the two teams faced each other in the league, unfortunately Andrew was not available which lead to Harrison Wilson stepping in, the 'I' team pinched the match 11-10 and provided perhaps the match of the season between young Charlie Williams and Oliver Stanyer-Jones. Both players received a chorus of applause from all the parents at the conclusion of the match which went Oliver's way 11-8 in the 5th. A special mention has to go to the only girls team in the division Crosby High 'H' Kaitlyn Dempsey (Jack's sister) and her friend Emma Warwick-Davis, the girls have turned up week after week, constantly playing with smiles on their faces (unlike Jack) and regardless of win or lose they have encapsulated the spirit of the JDD.

Although the JDD league has come to a close the 'Bill Harris Cup' winners have yet to be decided. Anfield 'A's James O'Dwyer and Dominic Birkbeck will contest the final against Crosby High 'E's Ciaran Lynch and Harry Griffiths. This is to be played on Wednesday 21st March at Crosby High.

The end of season tournament takes place on Sunday 25th March at the Anfield Sports & Community Centre followed by a presentation evening to be arranged at St Johns school.

---

---

To All players , all level, take time to watch and encourage the young players of the future, you will surely be surprised at the standard!

**Frank Murphy Vets. Handicap Cup  
Season 2017 - 2018**

**Round 1 RESULTS**

MAGHULL 1	375	V	371	CADWA 1
WAVERTREE LAB.1	421	V	450	WATERLOO 2
CADWA 3	0	V	378	MAGHULL 3 (w/o)
M/SIDE POLICE 2	447	V	441	ARRIVA N.W. 2
CADWA 2	424	V	397	LINACRE 2
BOOTLE YMCA 2	???	V	x	LINACRE 1
M/SIDE POLICE 1	431	V	394	BATH St. MARINE 1
SEFTON PARK 4	385	V	422	BATH St. MARINE 5
WAVERTREE LAB.3	338	V	348	BATH St. MARINE 3
WAVERTREE LAB.2	459	V	408	SEFTON PARK 3
WATERLOO 1	0	V	378	EAST WAVERTREE 2 (w/o)
BATH St. MARINE 2 (w/o)	378	V	0	ARRIVA N.W.
MAGHULL 2	272	V	355	BATH St. MARINE 6
SEFTON PARK 2	370	V	365	EAST WAVERTREE 1
BOOTLE YMCA 1	375	V	397	SEFTON PARK 1
BATH St. MARINE 4	424	V	379	ARRIVA N.W. 3

**Round 2 RESULTS**

HOME				AWAY	
BATH St. MARINE 3	373	v	340	M/SIDE POLICE 1	
BATH St. MARINE 4	460	v	429	LINACRE 2	
CADWA 2	368	v	417	SEFTON PARK 2	
MAGHULL 1	381	v	441	BOOTLE YMCA 2	
BATH St. MARINE 5	406	v	322	M/SIDE POLICE 2	
MAGHULL3	W/O	v	0	EAST WAVERTREE 2 (w/o)	
BATH St. MARINE 6	357	v	341	BATH St. MARINE 2	
WAVERTREE LAB.2	0	v	W/O	WATERLOO 2	

**Third Round DRAW**

Matches to be played week Comm. 19th March 2018

HOME				AWAY	
BATH St. MARINE 5		v		MAGHULL3	
BATH St. MARINE 3		v		SEFTON PARK 2	
BATH St. MARINE 6		v		BATH St. MARINE 4	
BOOTLE YMCA 2		v		WATERLOO 2	

**Liverpool & District Table Tennis League  
League Divisional Cups  
SEMI-FINAL RESULTS**

**Division 1. Readman Cup**

MAGHULL	5	v	0	MERSEYSIDE POLICE A
MERSEYSIDE POLICE	5	v	0	JAGUAR LANDROVER

**Division 2. Rumjahn Cup**

CADWA	5	v	1	WAVERTREE LAB. A
EAST WAVERTREE A	5	v	1	BOOTLE YMCA

**Division 3. Hyde Cup**

BATH St. MARINE C	0	v	5	WAVERTREE LAB. C
SEFTON PARK	4	v	5	ST. ANNES

**Division 4. Forrest Cup**

WATERLOO A	4	v	5	WATERLOO
Q.V.C.	5	v	2	WAVERTREE LAB. E.

**Division 5. Stamp Cup**

MAGHULL E	5	v	0	WAVERTREE LAB. F
MAGHULL D	0	v	5	WATERLOO B

**LEAGUE CUP FINALS**

**T.B. PLAYED WEEK BEG. 23RD. APR 2018**

**Division 1. Readman Cup**

MAGHULL	V	M/SIDE POLICE
---------	---	---------------

**Division 2. Rumjahn Cup**

CADWA	V	EAST WAVERTREE 'A'
-------	---	--------------------

**Division 3. Hyde Cup**

ST. ANNES	V	WAVERTREE LAB. 'C'
-----------	---	--------------------

**Division 4. Forrest Cup**

QVC	V	WATERLOO
-----	---	----------

**Division 5. Stamp Cup**

MAGHULL 'E'	V	WATERLOO 'B'
-------------	---	--------------

## Junior Development Division 2017 - 18 Season Final Tables

**J.D.D. Division 1**

	<b>Team</b>	<b>P</b>	<b>W</b>	<b>D</b>	<b>L</b>	<b>SF</b>	<b>SA</b>	<b>GF</b>	<b>GA</b>	<b>Pts.</b>
1	CH Anfield A	9	7	0	2	34	11	109	53	<b>109</b>
2	CH Marine B	9	8	0	1	32	13	109	56	<b>109</b>
3	CH Marine A	9	6	1	2	29	16	104	64	<b>104</b>
4	Crosby High A	9	6	1	2	30	15	98	68	<b>98</b>
5	Crosby High D	9	6	0	3	25	20	86	68	<b>86</b>
6	Crosby High B	9	3	1	5	21	24	76	85	<b>76</b>
7	St Johns A	9	2	2	5	19	26	68	87	<b>68</b>
8	Crosby High E	9	1	1	7	13	32	61	112	<b>61</b>
9	Waterloo	9	3	0	6	14	31	60	104	<b>60</b>
10	Crosby High C	9	0	0	9	8	37	43	117	<b>43</b>

**J.D.D. Division 2**

	<b>Team</b>	<b>P</b>	<b>W</b>	<b>D</b>	<b>L</b>	<b>SF</b>	<b>SA</b>	<b>GF</b>	<b>GA</b>	<b>Pts.</b>
1	Crosby High F	9	8	0	1	38	7	124	35	<b>124</b>
2	Crosby High I	9	8	0	1	37	8	115	36	<b>115</b>
3	St Johns C	9	6	0	3	31	14	104	62	<b>104</b>
4	CH Anfield B	9	5	0	4	25	20	86	69	<b>86</b>
5	Crosby High H	9	3	1	5	17	28	69	97	<b>69</b>
6	Crosby High G	9	2	2	5	18	27	67	92	<b>67</b>
7	St Johns D	9	4	0	5	17	28	67	95	<b>67</b>
8	St Johns B	9	3	1	5	17	28	63	90	<b>63</b>
9	Crosby High J	9	3	0	6	16	29	58	104	<b>58</b>
10	Crosby High K	9	1	0	8	9	36	45	118	<b>45</b>

# LEAGUE TABLES To 10/03/2018

DIVISION 1		P	W	D	Pts.
1	Crosby High	17	14	0	124
2	Maghull	16	15	0	121
3	Jaguar Land Rover	15	10	3	101
4	M/side Police	14	11	0	91
5	M/side Police A	17	7	1	76
6	Harold House	16	6	2	75
7	Wavertree Lab.	16	5	2	69
8	Greenbank	17	4	4	69
9	Bath St. Marine	15	6	1	67
10	Greenbank A	16	5	1	63
11	East Wavertree	16	3	1	51
12	Crosby High A	15	1	1	43

DIVISION 2		P	W	D	Pts.
1	Bath St. Marine A	17	13	0	123
2	East Wavertree B	16	11	3	112
3	Maghull A	15	10	2	93
4	M/side Police B	16	8	1	91
5	Cadwa	15	10	2	89
6	East Wavertree A	16	10	0	83
7	Bootle Ymca A	17	8	0	81
8	Bootle YMCA	16	6	4	80
9	Wav. Labour B	16	6	3	74
10	Wav. Labour A	17	2	2	58
11	Arriva North West	15	1	2	40
12	Bath St. Marine B	16	1	1	36

DIVISION 3		P	W	D	Pts.
1	Wav. Labour. C	15	12	2	119
2	Maghull B	16	13	3	114
3	Bath St. Marine D	16	9	2	99
4	Bath St. Marine C	16	9	4	93
5	CADWA A	15	8	3	86
6	CADWA B	15	7	2	72
7	Bootle YMCA B	16	6	0	63
8	M/side Police C	15	4	4	62
9	Linacre	17	0	4	59
10	Arriva N. W. 'A'	16	5	0	58
11	Sefton Park	15	3	4	58
12	ST ANNES	16	2	4	57

DIVISION 4		P	W	D	Pts.
1	QVC	16	14	1	122
2	Wav. Labour D	15	11	3	91
3	Waterloo	16	7	4	91
4	Wav. Labour E	16	8	3	89
5	East Wavertree C	15	10	3	84
6	Bath St. Marine E	17	5	6	82
7	Waterloo A	16	7	1	81
8	Maghull C	16	6	4	77
9	Sefton Park A	16	4	4	74
10	Sefton Park C	15	3	1	60
11	Sefton Park B	16	1	3	51
12	Bootle YMCA C	16	1	3	48

DIVISION 5		P	W	D	Pts.
1	Waterloo B	15	12	3	118
2	Sefton Park D	16	9	5	96
3	Arriva N. W. 'B'	14	10	2	91
4	Harold House A	15	7	2	80
5	Maghull D	15	7	0	76
6	Maghull E	13	6	4	76
7	Greenbank B	14	5	3	71
8	Wav. Labour F	12	6	3	62
9	Bath St. Marine G	15	2	1	52
10	Wav. Labour G	14	1	3	49
11	Bath St. Marine F	13	0	0	9

Edited & printed - Roly Wright. (Bootle YMCA)

e - mail -: [roly@ttdigest.co.uk](mailto:roly@ttdigest.co.uk) mob - 07835242619 web site -: [www.ttdigest.co.uk](http://www.ttdigest.co.uk)